

RESIDENCE
PLOTS
& VILLAS

ZONE A

LAND PRICE: THB 9,500. - /m2 (leasehold)

LAND + VILLA:

*Below prices are based on an average plot size which suits the type of villa and includes the construction cost with a standard finishing

VILLA TYPE	KEMALA	TANAH
PLOT SIZE (m2)	1,300	2,000
NET LIVING AREA (m2)	289	492
POOL	optional	integrated
BEDROOM	3	4
BATHROOM	2 + toilet	3 + toilet
STARTING PRICE* (THB)	21,900,000	39,900,000

CUSTOMIZE YOUR VILLA DESIGN

Based on our basic villa designs we encourage you to optimize your villa and make it uniquely yours in a way that suits your budget, lifestyle and design preferences. Our internal project management team supports you in every step of the way to help you customize your plans.



Villa Kemala



Villa Tanah



Villa Tanah



Interior

For further information:

68/35 Mooban Hua Na, Nong Gae,
Petchkasem Road, Hua Hin
Prachuabkirikhan 77110
Thailand

T: +66 (0) 3253 8888

F: +66 (0) 3253 8889

E: sales@banyanthailand.com

www.banyanthailand.com

"Disclaimer : This brochure is meant only for promotional purpose and has no legal value. The plans, specifications, images and the details herein are only indicative and for general information and no warranties or representations are made, express or implied, as to the correctness thereof and are no substitute for physical inspection by the recipient. Banyan reserves the right to change any or all of these in the interest of the development without prior notice or obligation. This printed material does not constitute an offer and/or contract of any type between Banyan and the recipient. Any purchase/lease of this development shall solely be governed by the terms and conditions of the Agreement for Sale/Lease between the relevant parties and no details mentioned in this printed material shall in any way govern or apply in such transaction."

RESIDENCE
PLOTS
& VILLAS

ZONE B

LAND PRICE: THB 9,000. - /m2 (leasehold)

LAND + VILLA:

*Below prices are based on an average plot size which suits the type of villa and includes the construction cost with a standard finishing

VILLA TYPE	BAYU	BENUA	KEMALA
PLOT SIZE (m2)	700	850	1,000
NET LIVING AREA (m2)	154	196	289
POOL	optional	infinity	optional
BEDROOMS	2	2	3
BATHROOMS	2	2 + toilet	2 + toilet
STARTING PRICE* (THB)	11,900,000	14,900,000	18,900,000

CUSTOMIZE YOUR VILLA DESIGN

Based on our basic villa designs we encourage you to optimize your villa and make it uniquely yours in a way that suits your budget, lifestyle and design preferences. Our internal project management team supports you in every step of the way to help you customize your plans.



Villa Bayu



Villa Benua



Villa Kemala



Interior

For further information:

68/35 Mooban Hua Na, Nong Gae,
Petchkasem Road, Hua Hin
Prachuabkirikhan 77110
Thailand

T: +66 (0) 3253 8888

F: +66 (0) 3253 8889

E: sales@banyanthailand.com

www.banyanthailand.com

"Disclaimer : This brochure is meant only for promotional purpose and has no legal value. The plans, specifications, images and the details herein are only indicative and for general information and no warranties or representations are made, express or implied, as to the correctness thereof and are no substitute for physical inspection by the recipient. Banyan reserves the right to change any or all of these in the interest of the development without prior notice or obligation. This printed material does not constitute an offer and/or contract of any type between Banyan and the recipient. Any purchase/lease of this development shall solely be governed by the terms and conditions of the Agreement for Sale/Lease between the relevant parties and no details mentioned in this printed material shall in any way govern or apply in such transaction."

PRICELIST

PRICELIST FOR VILLA TYPE



VILLA BAYU

Starting from THB 6,300,000



VILLA BENUA

Starting from THB 8,100,000



VILLA KEMALA

Starting from THB 11,000,000



VILLA TANAH

Starting from THB 22,000,000

For further information:

68/35 Mooban Hua Na, Nong Gae,
Petchkasem Road, Hua Hin
Prachuabkirikhan 77110
Thailand

T: +66 (0) 3253 8888

F: +66 (0) 3253 8889

E: sales@banyanthailand.com

www.banyanthailand.com

Note: As all villa's are customized, these are indicational prices based on the construction cost of a standard finished villa type.

All above prices are quoted in Thai Baht. The currency exchange rate is based on the time of printing and subject to change without prior notice due to currency fluctuation.

"Disclaimer : This brochure is meant only for promotional purpose and has no legal value. The plans, specifications, images and the details herein are only indicative and for general information and no warranties or representations are made, express or implied, as to the correctness thereof and are no substitute for physical inspection by the recipient. Banyan reserves the right to change any or all of these in the interest of the development without prior notice or obligation. This printed material does not constitute an offer and/or contract of any type between Banyan and the recipient. Any purchase/lease of this development shall solely be governed by the terms and conditions of the Agreement for Sale/Lease between the relevant parties and no details mentioned in this printed material shall in any way govern or apply in such transaction."

GENERAL PROJECT INFORMATION

Development	Banyan Residences Villas
Developer	Blue Lotus Hua Hin (Thailand) Company Limited
Site Location	200 km drive from Bangkok 5 minutes drive from Hua Hin center and the beach
Development Area	150,000 m2
Number of villas	102 villas
Privileges	<ul style="list-style-type: none"> • Membership at Banyan Golf Club, Hua Hin (<i>optional</i>) • Banyan Privilege card for all Residents Special benefits at several restaurants, beach clubs, water park and sport facilities (fitness, tennis etc.)
Common Services	<ul style="list-style-type: none"> • Residences management • Maintenance common areas and infrastructure • 24/7 security service
Residential Services (<i>optional</i>)	<ul style="list-style-type: none"> • Housekeeping • Garden and pool service • Pest control <p><i>Remark: Prices are based on a customized package</i></p>
Project management service (<i>optional</i>)	<p>We offer a professional project manager who will manage the construction from a draft design until completion of the villa.</p> <p><i>Remark: The project management fee is 5% of the total construction costs.</i></p>



For further information:

68/35 Mooban Hua Na, Nong Gae,
Petchkasem Road, Hua Hin
Prachuabkirikhan 77110
Thailand

T: +66 (0) 3253 8888

F: +66 (0) 3253 8889

E: sales@banyanthailand.com

www.banyanthailand.com

"Disclaimer : This brochure is meant only for promotional purpose and has no legal value. The plans, specifications, images and the details herein are only indicative and for general information and no warranties or representations are made, express or implied, as to the correctness thereof and are no substitute for physical inspection by the recipient. Banyan reserves the right to change any or all of these in the interest of the development without prior notice or obligation. This printed material does not constitute an offer and/or contract of any type between Banyan and the recipient. Any purchase/lease of this development shall solely be governed by the terms and conditions of the Agreement for Sale/Lease between the relevant parties and no details mentioned in this printed material shall in any way govern or apply in such transaction."

PAYMENT
CONDITIONS

PRIVILEGED GOLF MEMBERSHIP FOR BANYAN RESIDENTS

Application fee	3-year membership	THB 300,000+
	5-year membership	THB 450,000+
	10-year membership	THB 700,000+
<i>Membership fees subject to 7%VAT</i>		

PAYMENT CONDITIONS

Reservation fee	THB 400,000
Full payment of land lease	At execution of agreements
Villa construction cost	In milestones according to progress construction
Common fee	THB 4,502.- / month up to 1,000 m ² plot size THB 2.25 / month each additional m ² plot size
Electricity	THB 5 per Kw/h
Water	THB 18 per m ³
Registration fee land (lease)	1.1% of the total land price



For further information:

68/35 Mooban Hua Na, Nong Gae,
Petchkasem Road, Hua Hin
Prachuabkirikhan 77110
Thailand

T: +66 (0) 3253 8888
F: +66 (0) 3253 8889
E: sales@banyanthailand.com

www.banyanthailand.com

"Disclaimer : This brochure is meant only for promotional purpose and has no legal value. The plans, specifications, images and the details herein are only indicative and for general information and no warranties or representations are made, express or implied, as to the correctness thereof and are no substitute for physical inspection by the recipient. Banyan reserves the right to change any or all of these in the interest of the development without prior notice or obligation. This printed material does not constitute an offer and/or contract of any type between Banyan and the recipient. Any purchase/lease of this development shall solely be governed by the terms and conditions of the Agreement for Sale/Lease between the relevant parties and no details mentioned in this printed material shall in any way govern or apply in such transaction."

STANDARD SPECIFICATION LIST

STANDARD SPECIFICATION LIST BANYAN VILLA

AREA	DESCRIPTION MATERIAL
FLOORS	
Indoor living area	Ceramic tile or natural stone finishing
Outdoor terrace	Ceramic tile or natural stone finishing
Bedrooms	Ceramic tile or natural stone or engineering wood finishing
Bathrooms	Ceramic tile or natural stone finishing
Swimming pool	Ceramic tile or natural stone finishing
Entrance steps	Lava stone finishing
WALLS	
In/outdoor	Lightweight brick 20 cm Thk with cement plaster, skimming & paint finishing
Bathroom	Lightweight brick 20 cm Thk with cement plaster, ceramic tile finishing
Swimming pool	Ceramic tile or natural stone finishing
CEILING	
Height	3-meter from floor level
Indoor (dry areas)	Plasterboard with paint
Outdoor and Indoor wet areas	Moisture resistant plasterboard with paint
DOORS AND WINDOWS	
Main entrance door	Solid teak door 3" with teak frame
Exterior doors/windows	Aluminium powder coat frame with double glass and multi lock system
Interior door	Timber with plywood finishing 2"

AREA	DESCRIPTION MATERIAL
ROOFING	
Structure	Steel structure with a galvanized underpanel covering
Roof tiles	Roman style in a selection of 3 different plain colors (red/brown/charcoal)
SANITARY	
Water closet	Wall hung, brand Toto or equivalent
Lavatory	Under counter, brand Toto or equivalent
Faucet	Brand Toto or equivalent
Shower set	Built-in mixer with separate rain shower /hand shower, brand Toto or equivalent
Piping	Pimatec flex
WATER HEATER	
Boiler 300L	Hot water solar system, installed on the roof
ELECTRICAL	
MDB	Schneider with RCBO breaker switches
Switches / sockets	Schneider or equivalent
Swimming pool system	Brand Hayward, salt system
AIRCONDITIONING	
Concealed split	Daikin Inverter unit, capacity depending on the room size

For further information:

68/35 Mooban Hua Na, Nong Gae,
Petchkasem Road, Hua Hin
Prachuabkirikhan 77110
Thailand

T: +66 (0) 3253 8888
F: +66 (0) 3253 8889
E: sales@banyanthailand.com

www.banyanthailand.com

LEASEHOLD

ZONE A

THB 9,500 per Sqm

For further information:

68/35 Mooban Hua Na, Nong Gae,
Petchkasem Road, Hua Hin
Prachuabkirikhan 77110
Thailand

T: +66 (0) 3253 8888

F: +66 (0) 3253 8889

E: sales@banyan thailand.com

www.banyan thailand.com

ZONE A	AREA M ²	PRICE LAND
Plot 2	3,236.40	30,745,800.00
Plot 4*	2,456.00	67,500,000.00
Plot 5	2,075.60	19,718,200.00
Plot 6	2,164.00	20,558,000.00
Plot 8	2,072.00	19,684,000.00
Plot 11	1,818.00	17,271,000.00
Plot 14	1,478.00	14,041,000.00
Plot 14A	1,293.00	12,283,500.00
Plot 14-1B	1,354.00	12,863,000.00
Plot 17	1,478.00	14,041,000.00
Plot 17A	1,380.00	13,110,000.00
Plot 19	2,119.20	20,132,400.00
Plot 22	551.00	5,234,500.00
Plot 23	2,335.60	22,188,200.00

**Land Price Includes Villa*

LEASEHOLD

ZONE B

THB 9,000 per Sqm

ZONE B	AREA M ²	PRICE LAND
Plot 30D	1,566.40	14,097,600.00
Plot 31B	1,199.60	10,800,000.00
Plot 37	738.00	6,642,000.00
Plot 38	758.40	6,825,600.00
Plot 40	751.20	6,760,800.00
Plot 50	745.60	6,710,400.00
Plot 55A	748.00	6,732,000.00
Plot 56C	1,170.00	10,530,000.00

For further information:

68/35 Mooban Hua Na, Nong Gae,
Petchkasem Road, Hua Hin
Prachuabkirikhan 77110
Thailand

T: +66 (0) 3253 8888

F: +66 (0) 3253 8889

E: sales@banyanthailand.com

www.banyanthailand.com

LEASEHOLD

ZONE C

THB 8,500 per Sqm

For further information:

68/35 Mooban Hua Na, Nong Gae,
Petchkasem Road, Hua Hin
Prachuabkirikhan 77110
Thailand

T: +66 (0) 3253 8888

F: +66 (0) 3253 8889

E: sales@banyan thailand.com

www.banyan thailand.com

ZONE C	AREA M ²	PRICE LAND
Plot 62A	472.00	4,012,000.00
Plot 62B	599.00	5,091,500.00
Plot 63	514.00	4,369,000.00
Plot 64	527.00	4,479,500.00
Plot 65	816.00	6,936,000.00
Plot 67A	462.00	3,927,000.00
Plot 67B	576.00	4,896,000.00
Plot 68	642.00	5,457,000.00
Plot 69	516.00	4,386,000.00
Plot 79	670.00	5,695,000.00
Plot 81	635.00	5,397,500.00
Plot 82	567.00	4,819,500.00
Plot 94A	435.00	3,697,500.00
Plot 94B	583.00	4,955,500.00
Plot 95	661.00	5,618,500.00
Plot 98A	590.00	5,015,000.00
Plot 98B	671.00	5,703,500.00
Plot 104	1,021.20	8,680,200.00
Plot 118A	793.00	6,740,500.00

- RESIDENCE ZONE A
- RESIDENCE ZONE B
- RESIDENCE ZONE C
- BANYAN VILLAGE
- SOLD
- RESERVED

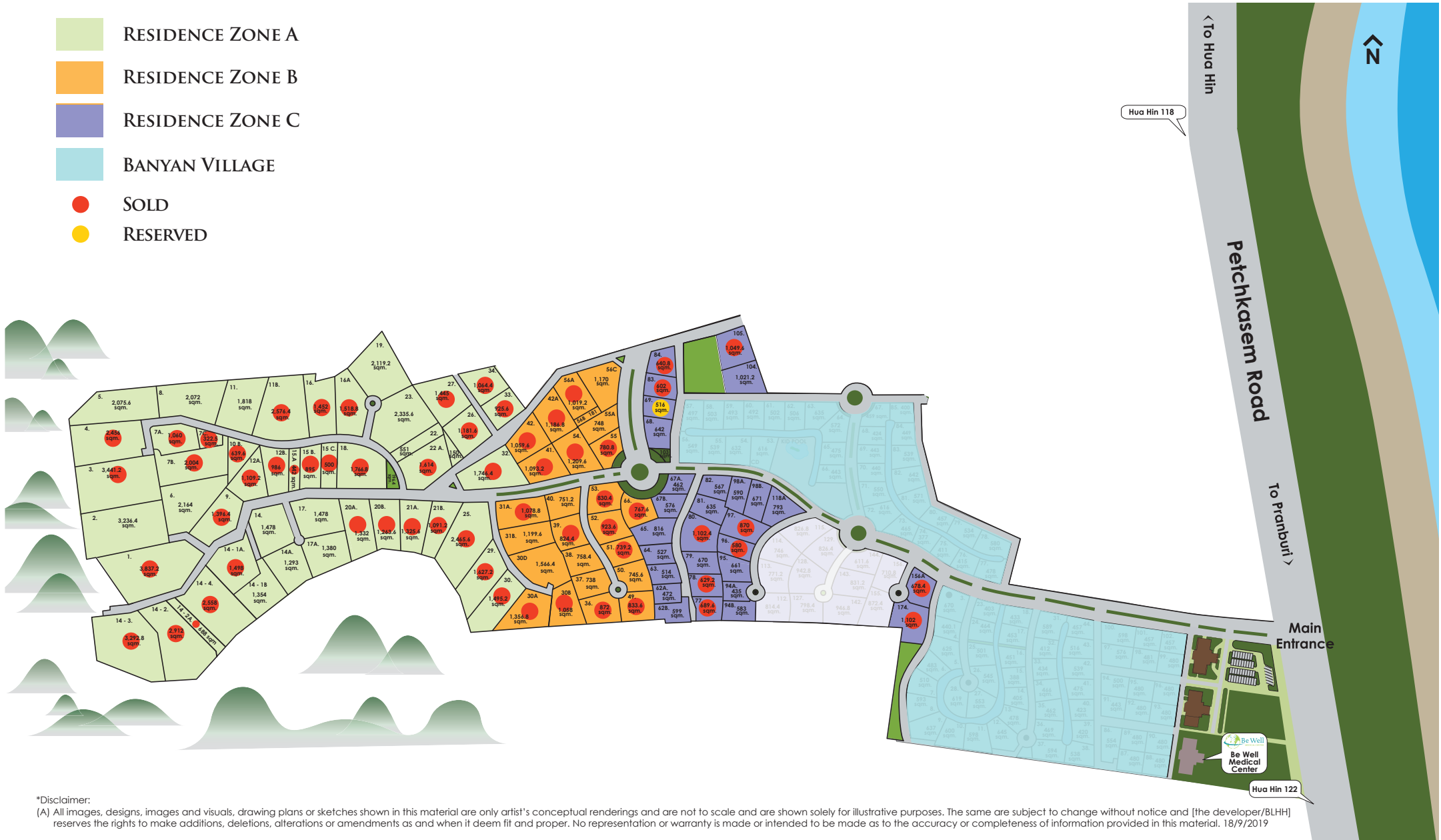

*Disclaimer:
 (A) All images, designs, images and visuals, drawing plans or sketches shown in this material are only artist's conceptual renderings and are not to scale and are shown solely for illustrative purposes. The same are subject to change without notice and [the developer/BLHH] reserves the rights to make additions, deletions, alterations or amendments as and when it deem fit and proper. No representation or warranty is made or intended to be made as to the accuracy or completeness of information provided in this material. 18/9/2019

Q: Where is the project located?

A: Banyan Residences is located 5 minutes away from the beach, shopping malls and international medical service Hospital.

Q: Can I enjoy sea view from my villa?

A: As the project is built on a hill side and located 1.5 km from the sea, our center and rear plots have sea view.

Q: Can I design my own villa?

A: Yes, if one of the existing 4 models is not the preferred design, customers are able to design their own layout, which can be converted by a professional team into a "Banyan style" villa.

Q: What other privileges are available for villa owners?

A: Our villa owners have privilege for benefits at several restaurants, beach club, water park and sport facilities (fitness, tennis) etc.

Q: Is there a golf membership included?

A: Villa owners have the privilege to apply for an exclusive golf membership at our Banyan Golf Club. The application fee depends on the membership.

- 3 year membership THB 300,000.-+
- 5 year membership THB 450,000.-+
- 10 year membership THB 700,000.-+

Membership fees subject to 7%VAT

The yearly fee is THB 26,550,- for the single membership and THB 42,470,- for a family membership, which covers up to 2 adults and 2 children under the age of 21. Members' guests (up to 3 people for each round) can also play at a guest rate when accompanied by a member. Members will be given priority when booking a tee-time.

Q: What does the price of a plot include?

A: The price of a plot includes a 3-phase underground electrical connection, Fiber optic connection and water supply.

Q: How about land ownership at Banyan for foreigners?

A: To realize the dream of owning a house in Thailand is to lease the land from the landlord (Banyan in this case). A lease of 30 years (longest period currently permitted by Thai law) will be signed between Banyan and the buyer. An agreement to lease the land for a total of 90 years will also be signed, which enables the owners to renew their leases for two additional 30-year periods. The price of the land covers the entire period of 90 years.

Q: What additional fees are involved when registering the lease with the local land office?

A: A villa owner needs to pay 1.1% of the land price "rent" as registration fee when the lease is registered at the provincial land office.

Q: Is it possible to acquire the land as freehold at the Banyan?

A: Due to the limited number of freehold plots which Banyan is entitled to sell by law every 3 years, a structure has been developed where the land will be registered as a leasehold first and converted into a freehold within a certain timeframe.

Q: What is the maximum timeframe to convert the leasehold into a freehold?

A: The exact timeframe of the conversion will depend on the number of clients who have signed for this structure and when a new quota of freehold plots will become available. Our sales team can provide you the details on the maximum timeframe of your preferred selected plot.

Q: Will there be any additional cost to convert a leasehold into a freehold?

A: A registration fee of 2% over the appraised value of the land will have to be paid to the land office at the time of the freehold registration.

Q: Does Banyan provide property management for home owners?

A: Banyan provides a comprehensive concierge/ facilities management service for home owners at a monthly fee starting from THB 9,000,-. The service comprises hospitality services, villa management, housekeeping, gardening, pool cleaning and maintenance, pest control, etc.

Q: What about home insurance?

A: There are many international insurance companies who provide property insurances. Banyan can support in recommending a preferred insurance company.

Q: Does Banyan provide a rental management service?

A: Banyan does not offer such a service at the moment, however can assist in liaising between professional real estate agents who are specialized in offering rental programs for each type of villa.

Q: How long will it take to construct a villa?

A: Depending on the villa model, it should take 10 to 12 months from start to finish. The buyer will be advised about the actual construction time by a detailed time schedule upon signing the contracts.

Q: How often is it required to visit Banyan during the construction period and is Banyan able to support in supervising the construction?

A: Banyan could provide a professional project management service, whereas supervising the construction is part of it in order to minimize any possible defects and maximize the quality of the construction. By having this service, owners will be updated on a daily basis by receiving a daily report and is visiting the Banyan on a regular basis not required.

Q: How much does a Project management service cost?

A: The price of a Project manager is 5% of the total construction cost.

Q: What is the warranty period for a villa?

A: 1-year warranty on the Mechanical and Electrical work and a 5-year warranty on the structural integrity of the villa, both commencing from the handover date of the villa.

Q: How to get Retirement Visa in Thailand.

A: Applicant must be 50 years of age or over and the applicant must meet one of the financial requirements ;
- Security deposit of THB 800,000 in a Thai bank account ;
or
- Monthly income of at least THB 65,000 ; or
- A total of 800,000 baht combination of personal bank deposit and income for the entire year.

Foreigners on a long term retirement visa in Thailand have to report to the local immigration officer every 90 days. After three years on a retirement visa the retiree can apply for Thai Permanent Residence status and no long is required to extend their visas